

SNOW THROWER



Depending on the model purchased, packaging will contain different accessories and parts. Refer to the package for more details.

KNOW YOUR MACHINE

1. Bail lever
2. Safety switch button
3. Chute control rod
4. Battery door
5. Chute deflector
6. Discharge chute
7. Scraper
8. Impeller
9. Quick-release handle
10. Low handle
11. Middle handle
12. Upper handle

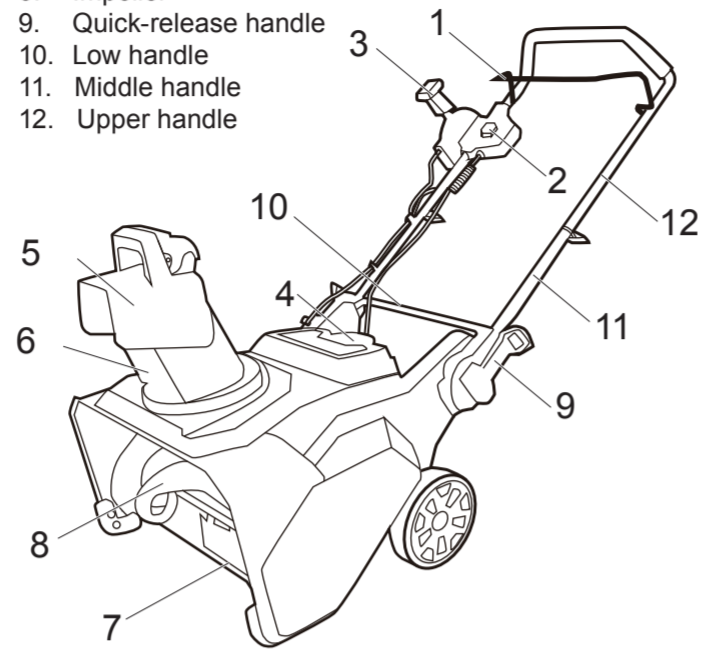

1

INSTALLATION

Assemble the handle

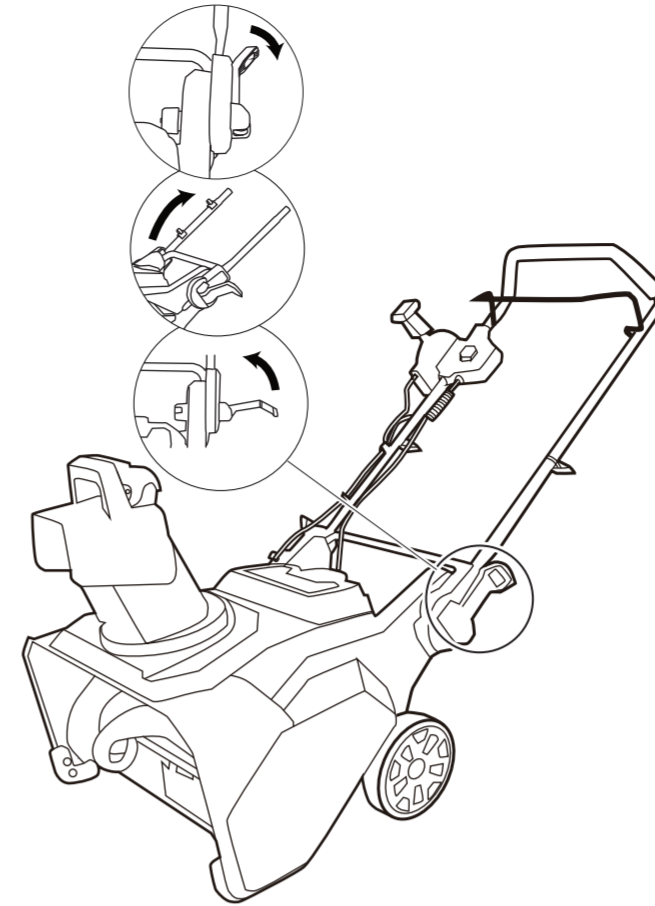

2

3

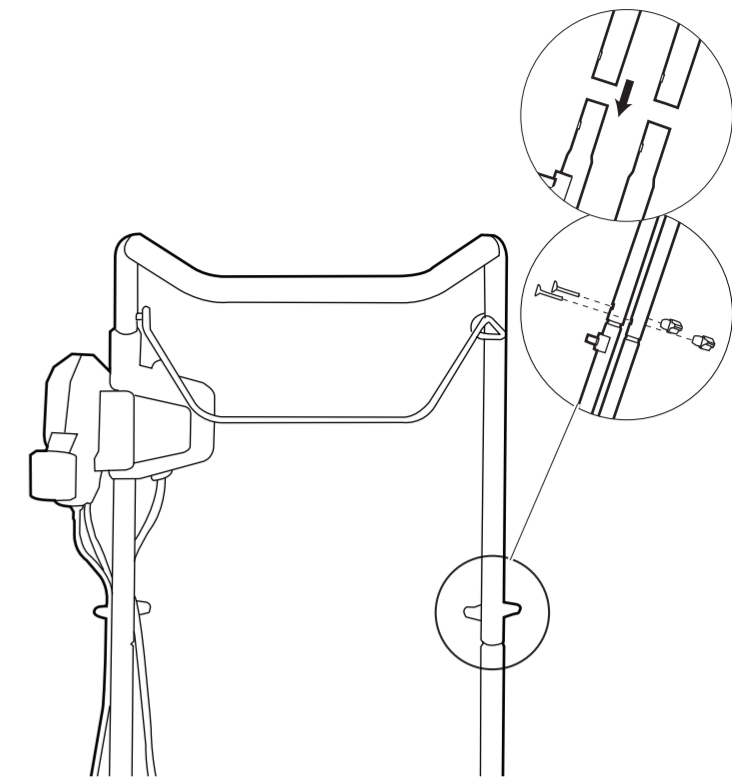

Install the chute-rotation box

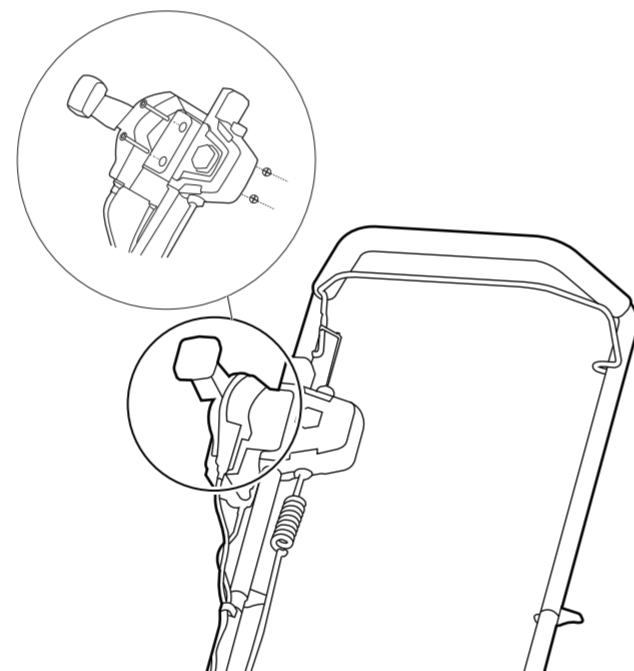

4

Assemble the chute deflector

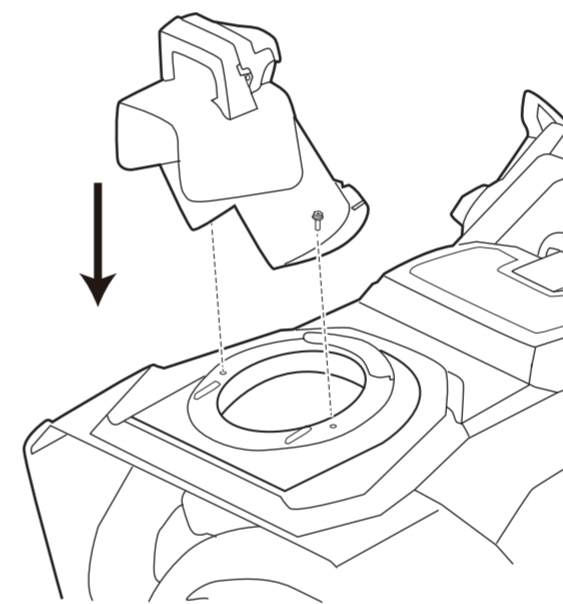

5

Install the battery

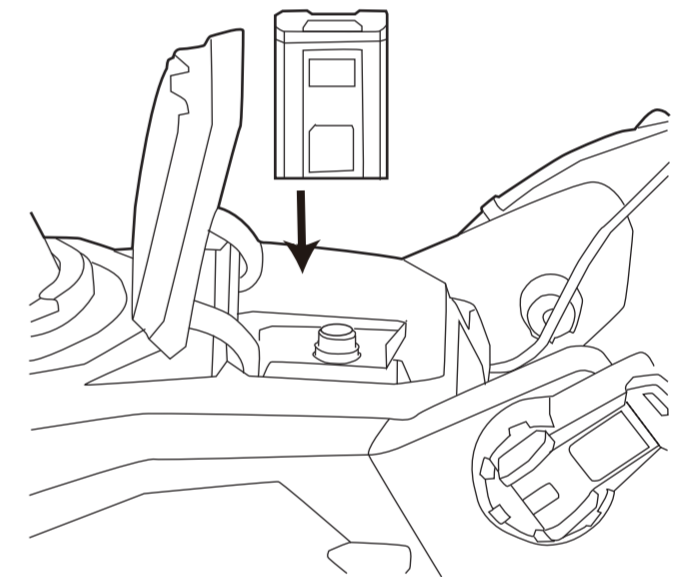

6



commercial.greenworkstools.com



www.shopgreenworksgear.com

P0804588-01 Rev B

OPERATION

Start the machine

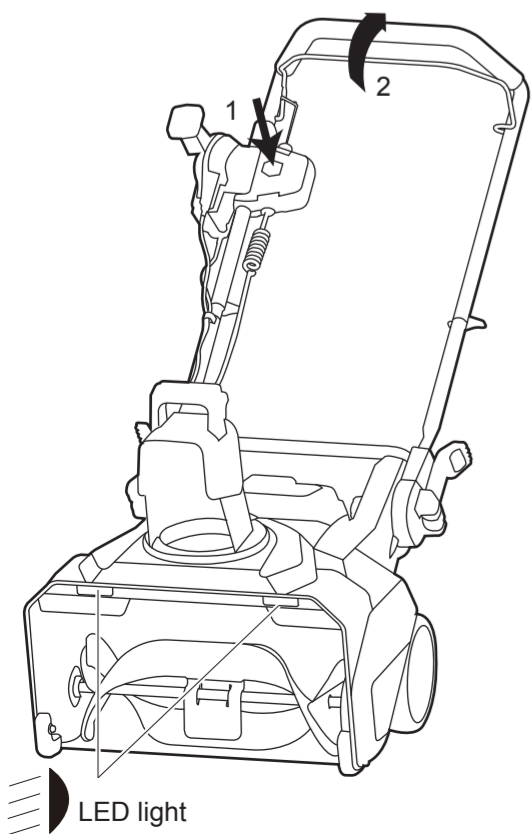

7

Blue LED light

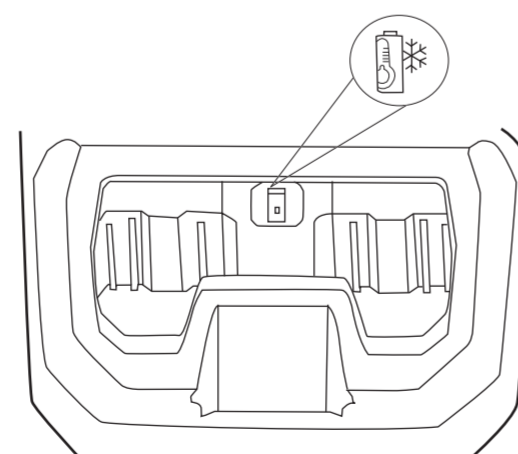

BLUE LED INDICATOR	
Low battery voltage	Flashing Blue Light
Low battery temperature	Solid blue light

8

Adjust the discharge chute

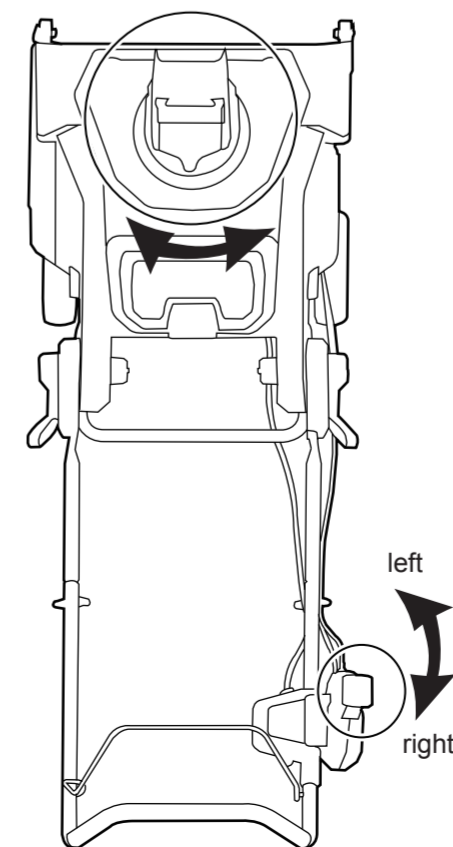

9

Adjust the chute deflector

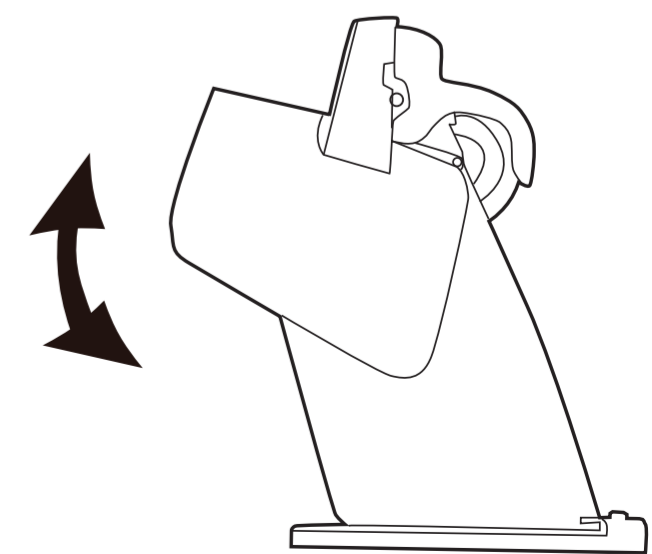

10

MAINTENANCE
Replace the scraper

11

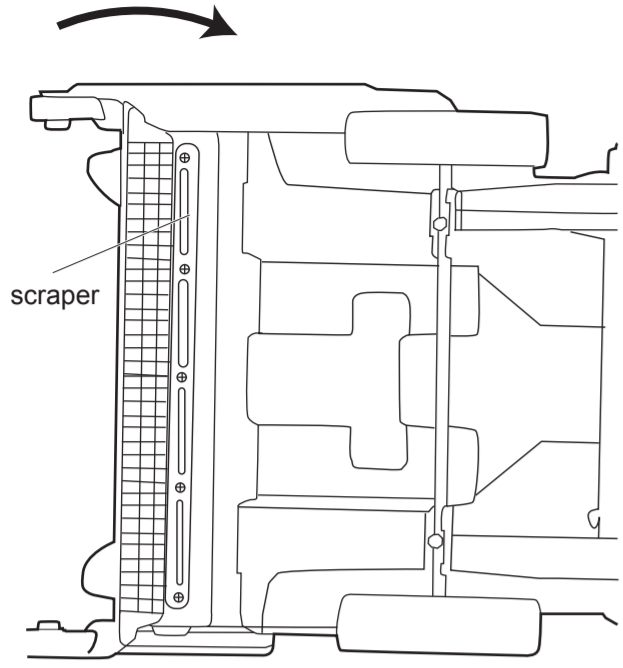

12

Replace the belt

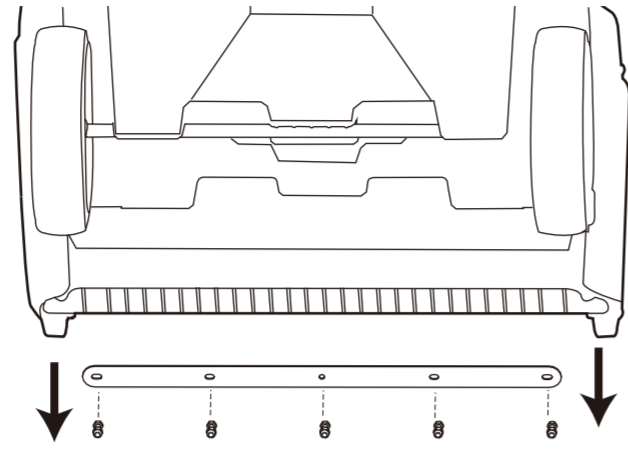

13

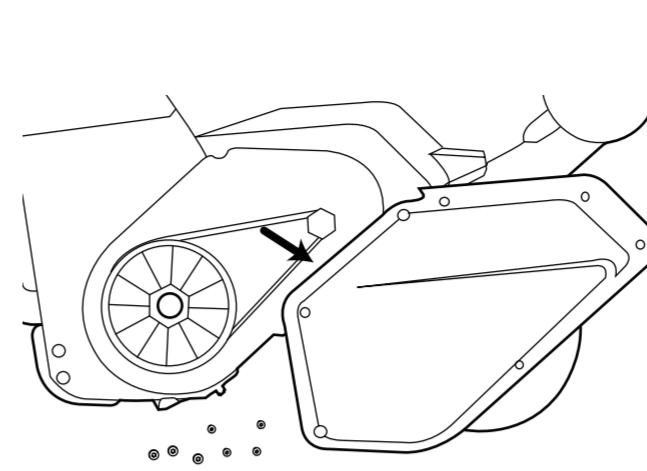

14

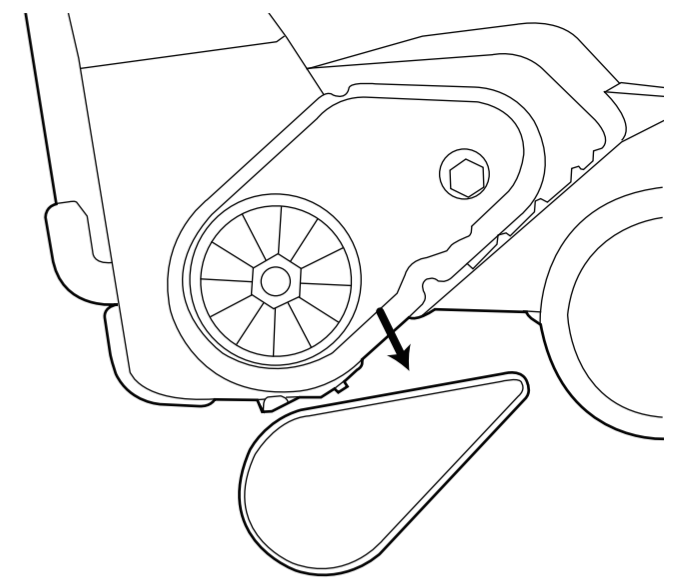

15

Replace the impeller

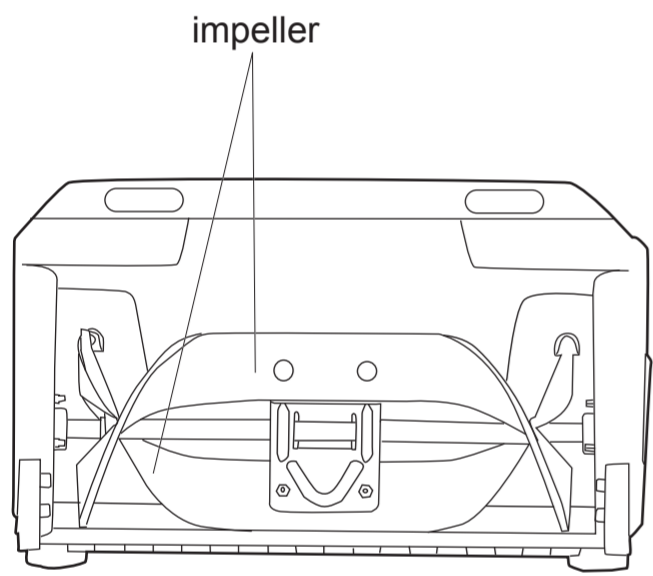

16

Replace the skid plates

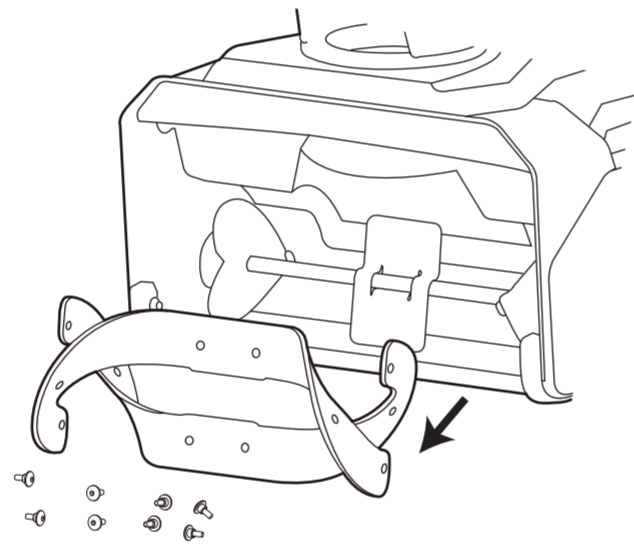

17

